

# STANDARD RANGE

Street lighting solutions

AVIKA2X25050 and AVIKA8X1

December, 2024

NEW



ø50 mm  
(for up to 5050)

# AVIKA2X25050

- Industry's standard AVIKA-2X2 lenses optimized for Illuminance and Luminance based roads with low threshold increment requirements.
- Optics are optimized for EN13201 M roads, providing excellent uniformity with minimized backlight
- First optics in the market passing requirements with both 5050 and 3535 LED packages
- Screw mounting from the middle
- >90% Optical efficiency
- Black mask available to minimize backlight in regulated areas for even better backlight control
- AVIKA is available for following IESNA classes
  - TYPE I MEDIUM
  - TYPE II SHORT
  - TYPE II MEDIUM
  - TYPE III SHORT
  - TYPE III MEDIUM
  - TYPE **T5M (Type 5, rounded square)**

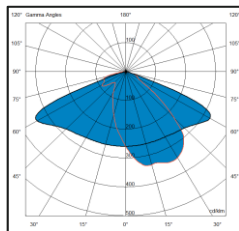

T2S

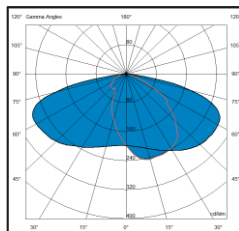

T3S

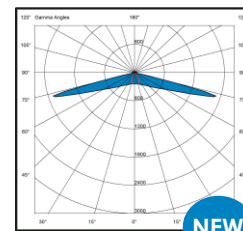

T1M

NEW

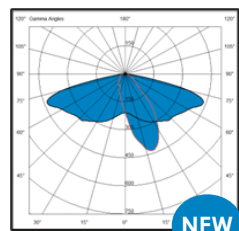

LN1

NEW

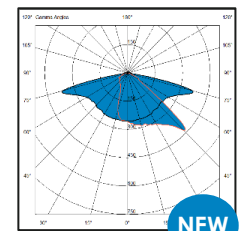

ME

NEW

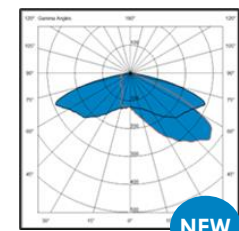

LW1

NEW

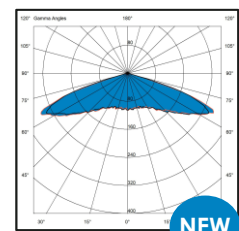

T5M

NEW



\*\* Photometries with protective glass

NEW



ø50 mm  
(for up to 5050)

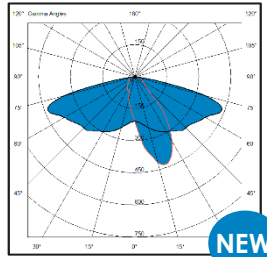

# AVIKA2X25050LN1

Regulation M3 road, motorway. IESNA TYPE II M

- 1. **Luminaires on the side:** (2 lanes, two way),
- LED Type: 5050 & 3535
  - **Average Road Brightness** : >1.0cd/m<sup>2</sup>(min)
  - **Width per lane** : **7m** (3.5m x 2)
  - Pole distance : **46 m**
  - Pole Height : **10 m**
  - Boom length : **1 meter**
  - Boom Angle : 0
  - Maintenance factor : 0.80
  - Overhang : 0 m
  - Pole distance to roadway: 0
  - Overall uniformity : U0: 0.45
  - Traffic lane uniformity : U1: 0.65
  - Edge illumination ratio : EIR: 0.3
  - Glare : TI: 11
  - Lumens : **14 000lm**
  - Road condition : **Tarmac (R3)**
- Luminous intensity class: CUTOFF

Available  
in recycled  
PMMA



Confidential



NEW



ø50 mm  
(for up to 5050)

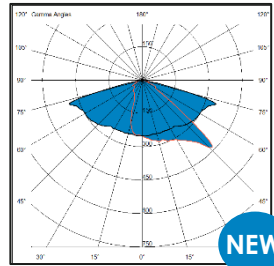

# AVIKA2X25050ME

Regulation M3 road, motorway. IESNA TYPE II M

- 1. **Luminaires on the side:** (3 lanes, one way),
- LED Type: 5050 & 3535
  - **Average Road Brightness** : >1.0cd/m<sup>2</sup>(min)
  - Width per lane : 10.5m (3.5m x 3)
- Pole distance : **45 m**
- Pole Height : **10 m**
- Boom length : **1 meter**
- Boom Angle : 0
- Maintenance factor : 0.80
- Overhang : -0.650 m
- Pole distance to roadway: 0
- Overall uniformity : U0: 0.55
- Traffic lane uniformity : UI: 0.70
- Edge illumination ratio : EIR: 0.7
- Glare : TI 13
- Lumens : 19 000
- Road condition : **Tarmac (R3)**
- Luminous intensity class: CUTOFF

Available  
in recycled  
PMMA



Confidential

NEW



ø50 mm  
(for up to 5050)

# AVIKA2X25050LW1

Regulation M3, roads with multiple lanes. Type III Medium.

**Luminaires on the side:** 1 Luminaire (4 lanes, two way),

- LED Type: 5050 & 3535
  - **Average Road Brightness** : >1.0cd/m<sup>2</sup>(min)
  - Width per lane : 15m (3.75m x 4)
  - Pole distance : **56 m**
  - Pole Height : **12 m**
  - Boom length : **1 m**
  - Boom Angle : 0-5
  - Maintenance factor : 0.80
  - Overhang : -2 m
  - Pole distance to roadway: 3
  - Overall uniformity : U0: 0.5min
  - Traffic lane uniformity : U1: 0.7min
  - Edge illumination ratio : EIR: 0.3min
  - Glare : TI= 11
  - Lumens : **31 500lm**
  - Road condition : **Tarmac (R3)**
- Target Luminous intensity class: CUTOFF

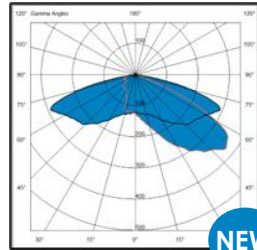

Available  
in recycled  
PMMA



Confidential



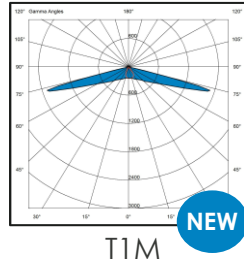
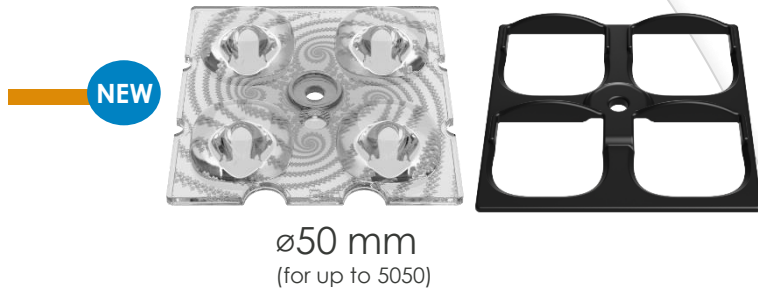

# AVIKA2X25050T1M

Regulation P4, Pedestrian road. Type I Medium.

**Luminaires on the side:** 1 Luminaire  
(2 lanes, bicycle/walking road)

- LED Type: 5050 & 3535
  - **Average Road Brightness** : >1.0cd/m<sup>2</sup>(min)
  - Width per lane : 7m (3.5m x 2)
  - Pole distance : **42 m**
  - Pole Height : **5 m**
  - Boom length : **0.5 - 1 m**
  - Boom Angle : 0-5
  - Maintenance factor : 0.80
  - Overhang : 0 m
  - Pole distance to roadway: 1
  - Lumens : **3000 lm**
  - **Em (lx): 6.50 lx**  
**Emin (lx) 1.55 lx**
  - Road condition : **Tarmac (R3)**
- Luminous intensity class: CUTOFF



Confidential

NEW

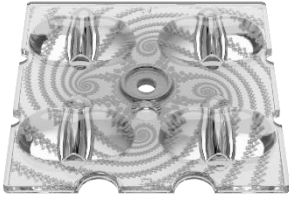

ø50 mm  
(for up to 5050)

## AVIKA2X25050T5M

Parking lot, Area and Wide area lighting  
IESNA Type 5 Medium (square)

- LED Type: 5050 & 3535
  - **Illuminance requirement: (Eav): 20 lx, Emin 11 lx, U0 0.6**
  - Pole distance : **25 m**
  - Pole Height : **5 m**
  - Boom length : **0 m**
  - Boom Angle : **0**
  - Maintenance factor : **0.80**
  - Overhang : **0 m**
  - Lumens : **16 000lm**
  - Road condition : **Tarmac (R3)**
- Target Luminous intensity class: Semi-cutoff

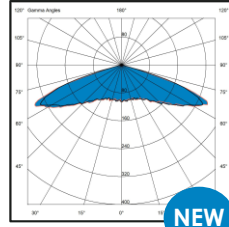

T5M

NEW



Confidential



NEW

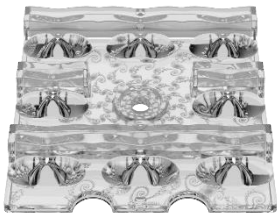

ø50 mm  
(for up to 3535)

# AVIKA8X1

- Industry's standard AVIKA-8X1 lenses optimized for Illuminance and Luminance based roads
- Optimized for High Power 3535 packages
- Excellent uniformity with minimized backlight and best lm/\$
- Screw mounting from the middle
- >90% Optical efficiency
- Black mask available to block backlight
- AVIKA is available for following IESNA classes
- TYPE I MEDIUM
- TYPE II MEDIUM
- TYPE III MEDIUM

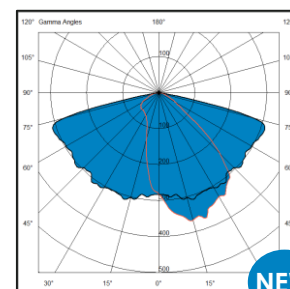
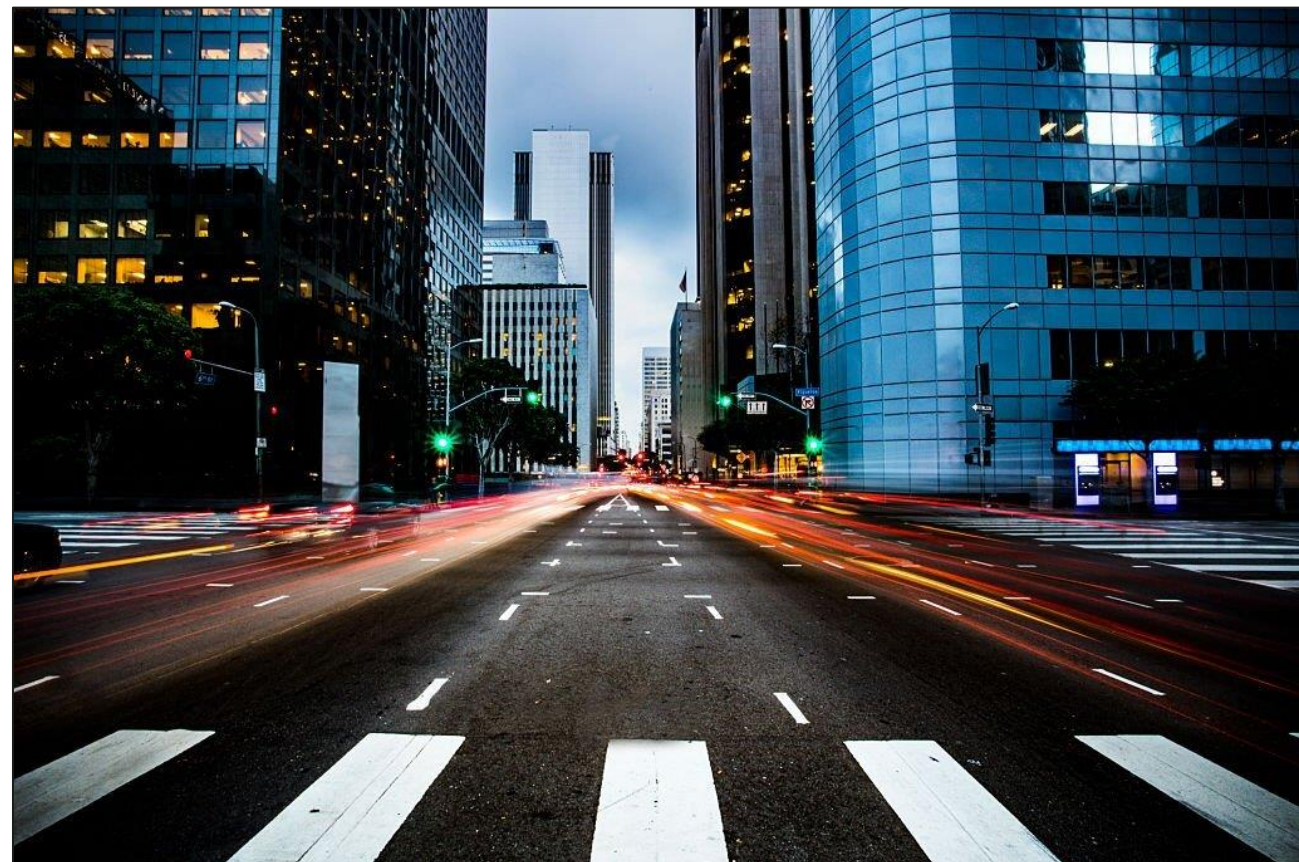

T1M

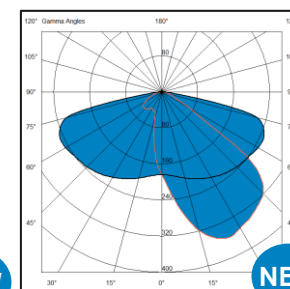

ME



Available in recycled PMMA

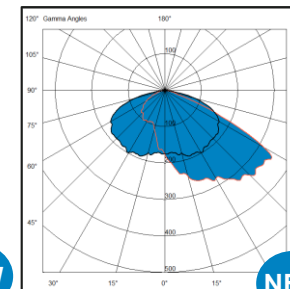

T3M



Available in recycled PMMA

## Confidential

\*\* Photometries with protective glass



# AVIKA: Mask Compatibilities

Optical component : AVIKA\* + Mask : AVIKA\*M

Optical component	Mask
AVIKA 2x2 5050 T3S	AVIKA 2x2 5050 T3S M
AVIKA 2x2 5050 T2S	AVIKA 2x2 5050 T2S M
AVIKA 2x2 5050 T3M	AVIKA 2x2 5050 T3M M
AVIKA 2x2 5050 T1M	M1 AVIKA 2X2 5050
AVIKA 2x2 5050 LN1	M1 AVIKA 2X2 5050
AVIKA 2x2 5050 ME	M1 AVIKA 2X2 5050
AVIKA 2x2 5050 LW1	M1 AVIKA 2X2 5050
AVIKA 2x2 5050 T5M	N/A
AVIKA 8X1 T1M	M1 AVIKA 8X1
AVIKA 8X1 ME	M1 AVIKA 8X1
AVIKA 8X1 T3M	M1 AVIKA 8X1

# AVIKA2X2: 2D drawing

All dimensions are in millimeters.

standard NF T 58-000 cat. 4, reduced class.

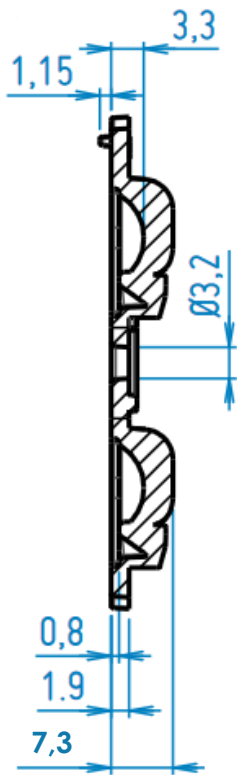
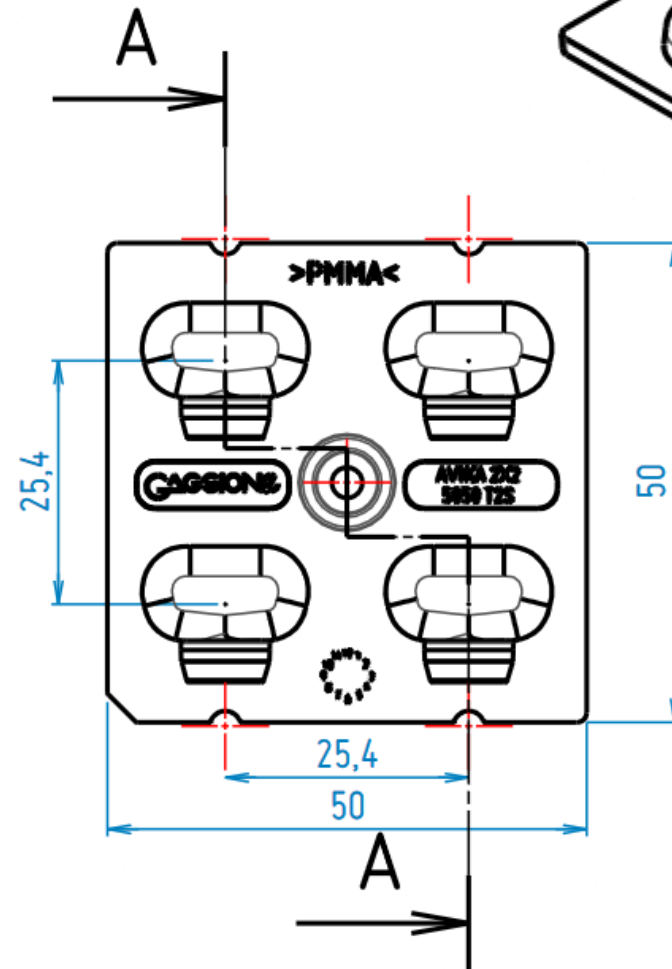
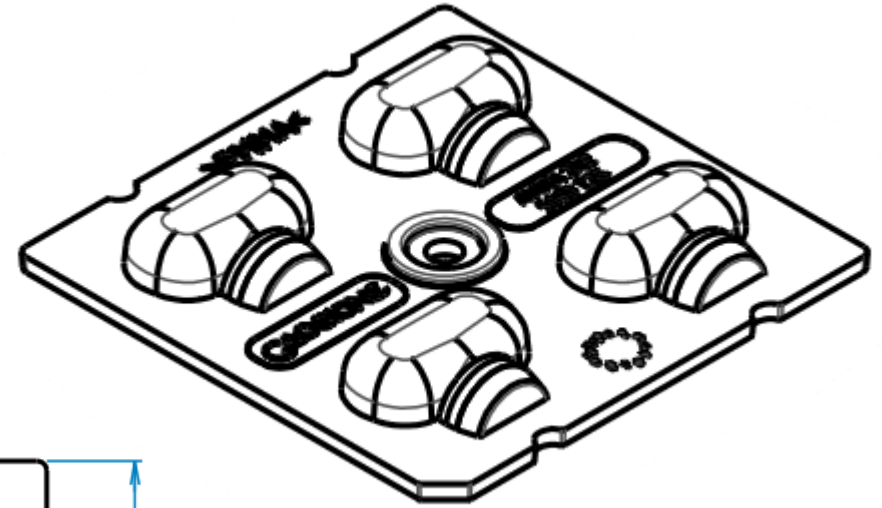
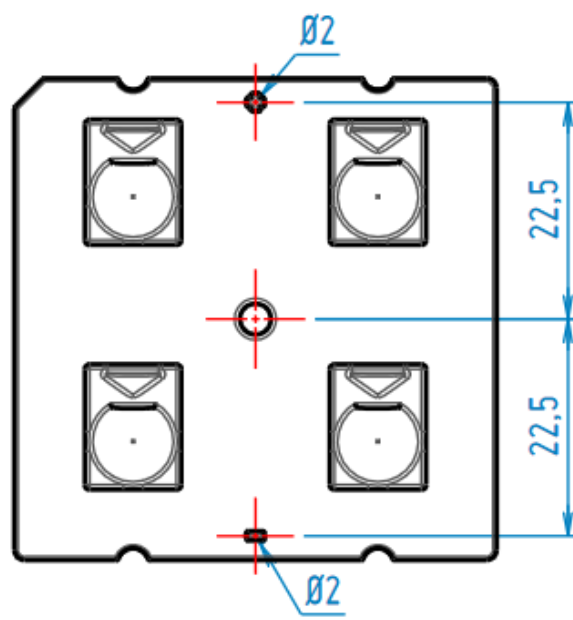



# AVIKA8X1: 2D drawing

All dimensions are in millimeters.

standard NF T 58-000 cat. 4, reduced class.

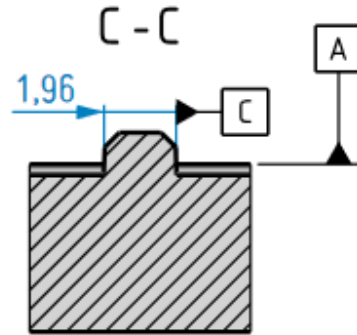
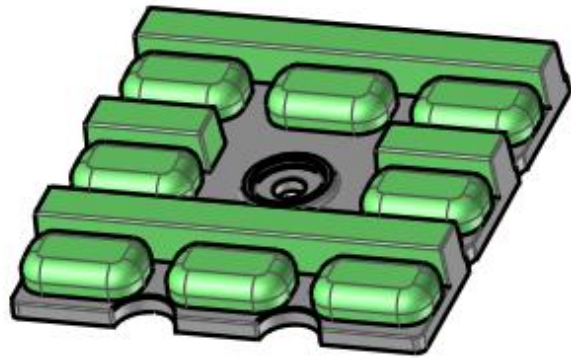

B - B

Detail D

Lens height : 7,1

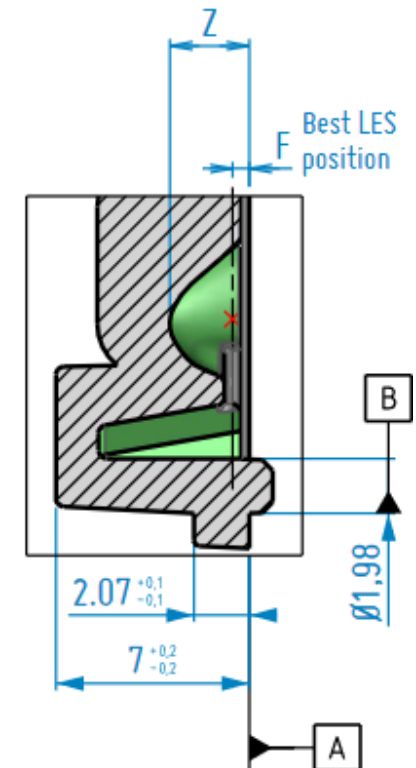
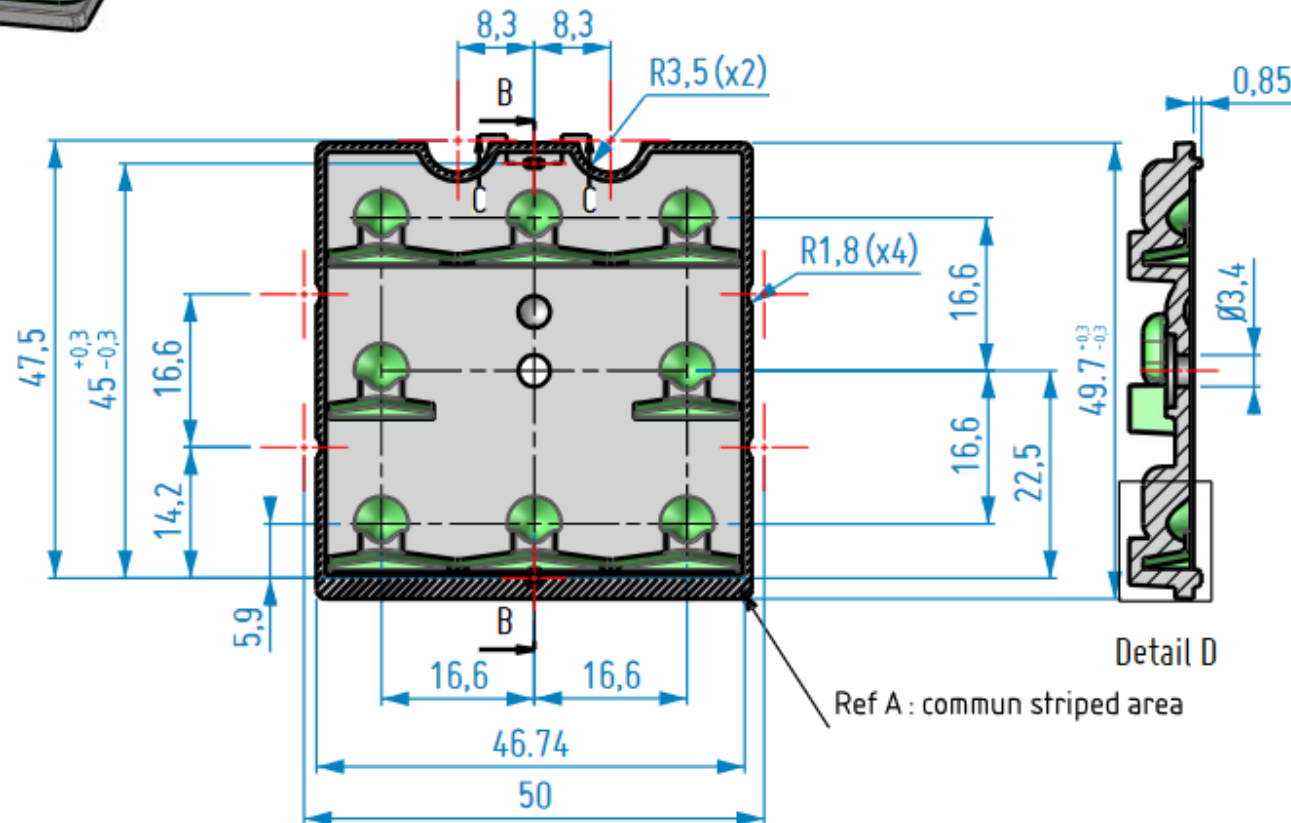

# AVIKA: Packaging

## AVIKA2X25050

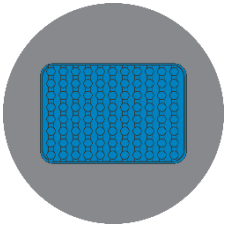

4 layers of 165 pieces  
individually packed



660 parts  
Box: 340x320x260mm  
Weight: 6 kg

## AVIKA8X1

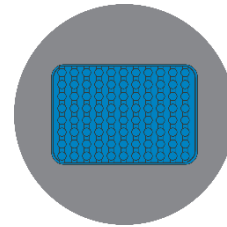

4 layers of 153 pieces  
individually packed



612 parts  
Box: 340x320x260mm  
Weight: 6 kg



# Code form standard range

## LENS

### OPTICAL

- 01: 16 mm
- 02: 16 mm
- 12: 16 mm
- 22: 16 mm RGBW
- 05: 32 mm
- 15: 32 mm
- 25: 32 mm RGBW
- 07: 35 mm
- 45: 45 mm UFO or VEGA
- 49: 45 mm RGBW
- 59: 45 mm RGBW gen 2
- 56: 67mm in PMMA
- 66: 67 mm in silicone
- 76: 67mm in silicone
- 67: 67 mm UFO

### PRODUCT

- LLC: Collimator
- LLH: Holder
- LLL: Linear collimator
- LLR: Reflector
- LLS: Set
- UFO: Ultra Flat Optic
- VEGA : 45mm COB oriented
- AVIKA : Street Lighting

### BEAM ANGLE

- U/R/RF/UF: Ultra Narrow
- N/NF: Narrow
- M: Medium
- W: Wide
- X: Extra large
- S: Super large
- L: Large
- V: Very large
- E: Elliptical
- Z: Zoom

### MATERIAL

- 0 or nothing : PMMA
- 1: PC
- 2: PC anti-UV
- 7: Silicone

LLS01W01ABC001

**ABC:** Holder type according to LED package

### COLORS & DECORS

- 0: Translucent
- 1: White
- 2: Black

### ADHESIVE OPTION

- 1: Yes
- Nothing: No

### VERSION

### TYPE

- 1: 16mm
- 2: 32mm
- 3: 3x16mm
- 4: 4x16mm
- 9: 45mm

## HOLDER

# Contact us

## GAGGIONE SAS Headquarter

3, Rue de la Rolland  
01460 Montréal la Cluse  
France

☎ +33 4 74 76 12 66  
@ [contact@gaggione.com](mailto:contact@gaggione.com)  
🌐 [www.optic-gaggione.com](http://www.optic-gaggione.com)

## Sales Team in GAGGIONE

Sandrine Mancuso  
France, UK, Italy, Spain

@ [s.mancuso@gaggione.com](mailto:s.mancuso@gaggione.com)  
☎ +33 787 87 84 72

Nicolas Golfier  
France, Scandinavia,  
Eastern and Northern Europe

@ [n.golfier@gaggione.com](mailto:n.golfier@gaggione.com)  
☎ +33 677 35 50 37

Sonia Andres  
France, Spain,

@ [s.andres@gaggione.com](mailto:s.andres@gaggione.com)  
☎ +33 607 37 20 28

Laurent Barel  
Sales & Marketing Director

@ [l.barel@gaggione.com](mailto:l.barel@gaggione.com)  
☎ +33 612 04 41 30

## International Sales Offices

GAGGIONE Americas  
Michael Pietro  
12833 Surrey Ct.  
Palos Park, IL  
60464

@ [m.pietro@gaggione.com](mailto:m.pietro@gaggione.com)  
☎ +1 224 392 0087

GAGGIONE Asia  
Zhen Xu  
Unit 1808, No. 8, Kuaiji Road,  
Jintiandi International building,  
Huangpu District,  
Shanghai, 200021, China

@ [z.xu@gaggione.com](mailto:z.xu@gaggione.com)  
☎ +86 136 5189 6981

GAGGIONE Canada  
Stephane Saindon  
744 36th Avenue  
Montreal, Quebec  
H8T3L2

@ [s.saindon@gaggione.com](mailto:s.saindon@gaggione.com)  
☎ +1 514 928 2179

GAGGIONE DACH  
Angelika Aigner  
Kreuzstrasse 7  
83355 Grabenstätt  
Germany

@ [a.aigner@gaggione.com](mailto:a.aigner@gaggione.com)  
☎ +49 8661 983 44 77

## Product Management & Business development

Joni MÄKI  
Artunkuja 7,  
24260 Salo  
FINLAND

@ [j.maki@gaggione.com](mailto:j.maki@gaggione.com)  
☎ +33 6 38 24 17 51